

Oscilloscope Test Probes

High Frequency Measurement



Altech High Frequency Test Probes are for direct connection to oscilloscopes. The line consists of a standard 5mm series with adjustable probe ratio and 2.5mm series with fixed 10:1 ratio.

- 10:1 probe ratio
- Exchangable spring tip
- Low Input Capacitance

Type

TKO 5 - PMS 221A

Passive High Impedance Miniature Test Probe with 150 MHz Bandwidth and Probe Ratio 10:1 (Switchable, 20 MHz @ Probe Ratio 1:1). The probe is adjustable for low frequencies.

Features:

- Modular Probe
- Coaxial Design
- Coaxial Reed Switch
- New IC contact system for 0.003" to 0.004" grids
- Interchangeable Spring Contact Tip for reliable Contacting

PART NO.

974312000

Technical Data

Probe Ratio	1:1	10:1
Input Resistance	-	10 MΩ
Input Capacitance	78 pF inkl. Oszi.	13 pF
Oscilloscope Input	1 MΩ AC/DC	1 MΩ AC/DC
Probe bandwidth	20 MHz	150 MHz
Risetime	18 nsec	2,4 nsec
Compensation Range		15 ... 40 pF
Measurement category	55 V eff. CAT II	300 V rms CAT II
Pollution degree	2	2
Safety standard	IEC 61010-031	
Cable length	1.2 m (3.94 ft.)	

Drawing

Measurements are shown in millimeters. Multiply by 0.03937 to convert to inches.

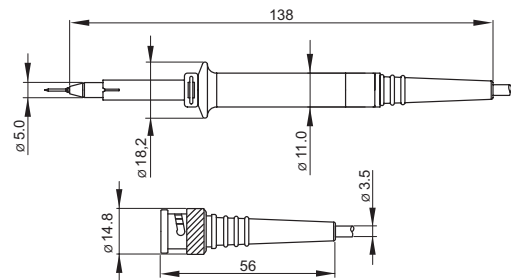

Contents



- Test Probe
- Manual
- Ground Lead 0.22m (0.72")
- Spring Tip 0.8mm (0.003")
- Solid Tip CuBe 0.8mm (0.003")
- Ground Blade 5.0mm (0.016")
- Isolation Cover 5.0mm (0.016")
- Protection Cover 5.0mm (0.016")
- IC covers 0.8 to 1.27mm (0.003-0.004")
- Spring Hook 5.0mm (0.016")
- Adjustment Tool T

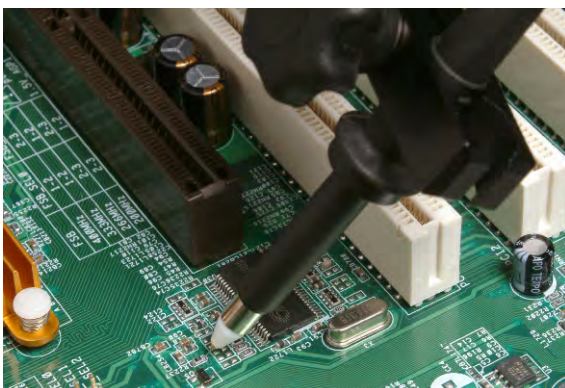
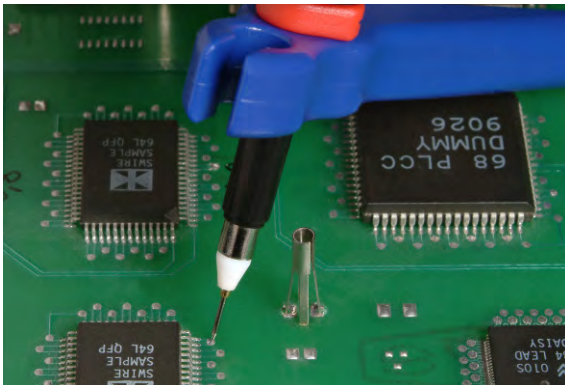



Type

TKO 2,5 - PML 711A

Passive High Impedance Miniature Test Probe with 500 MHz Bandwidth and Probe Ratio 10:1. Designed for Oscilloscopes having 1M Ω Input resistance.

Features:

- Compact Size (0.008" probe tip) ideal for measuring SMD Components
- 0.002" gold plated spring loaded changeable Probe tip
- Innovative IC contact system for 0.002" to 0.004" grids
- With ReadOut (RO)

PART NO.

974301000



TKO 5 - PMT 221A

Passive High Impedance Miniature Test Probe with 250 MHz Bandwidth and Probe Ratio 10:1 (Switchable, 30 MHz @ Probe Ratio 1:1). The probe is adjustable for low frequencies.

Features:

- Modular Probe
- Coaxial Design
- Coaxial Reed Switch
- Innovative IC contact system for 0.003" to 0.004" grids
- Interchangeable Spring Contact Tip for reliable Contacting
- HF- Adjustment

PART NO.

974311000

Technical Data

Probe Ratio	10:1
Input Impedence	10 M Ω
Input Capacitence	9,5 pF
Oscilloscope Input	1 M Ω AC/DC
Probe bandwidth (3dB)	500 MHz
Risetime (10% - 90%)	700 psec
Compensation Range	10 ... 25 pF
Measurement category	300 V CAT II
Pollution degree	2
Safety standard	IEC 61010-031
Cable length	1.3 m (4.27 ft.)

1:1	10:1
-	10 M Ω
80 pF inkl. Oszi.	13 pF
1 M Ω AC/DC	1 M Ω AC/DC
30 MHz	250 MHz
12 nsec	1,4 nsec
-	10...35 pF (**)
55 V eff. CAT II	300 V rms CAT II
2	2
IEC 61010-031	
1.2 m (3.94 ft.)	

Drawing

Measurements are shown in millimeters. Multiply by 0.03937 to convert to inches.

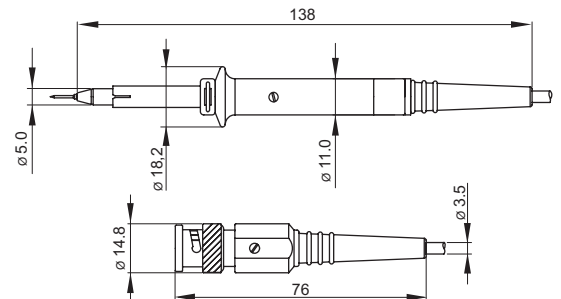
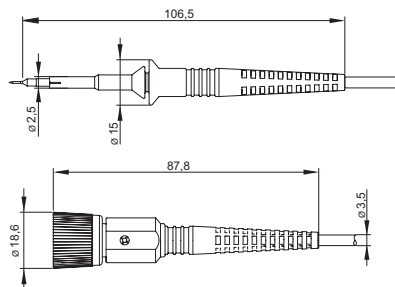

Contents



- | | | | |
|--|---|--|---|
| <ul style="list-style-type: none"> • Test Probe • Manual • Spring Tip gold plated 0.5mm (0.002") • Solid Tip CuBe 0.5mm (0.002") • Coding Rings (3x4 colors) • Ground Lead 0.11m (0.36") • Ground Blade 2.5mm (0.008") • 2 self adhesive Cu Pads | <ul style="list-style-type: none"> • Isolation Cover 2.5mm (0.008") • Protection Cover 2.5mm (0.008") • IC covers 0.5 to 1.27mm (0.002-0.004") • Spring Hook 2.5mm (0.008") • Ground Spring 2.5mm (0.008") • PCB Adapter Kit 2.5mm (0.008") • 2 Foot Positioner • Adjustment Tool T | <ul style="list-style-type: none"> • Test Probe • Manual • Ground Lead 0.22m (0.72") • Spring Tip 0.8mm (0.003") • Solid Tip CuBe 0.8mm (0.003") • Ground Blade 5.0mm (0.016") • Isolation Cover 5.0mm (0.016") | <ul style="list-style-type: none"> • Protection Cover 5.0mm (0.016") • IC covers 0.8 to 1.27mm (0.003-0.004") • Spring Hook 5.0mm (0.016") • BNC Adapter 5.0mm (0.016") • 2 Foot Positioner • Adjustment Tool T |
|--|---|--|---|